

BUYING - BRICKWORK SUPPORT SYSTEMS

Design Considerations

Structures with brick or stone cladding will usually necessitate the use of stainless steel support for the masonry over horizontal movement joints. Differential movement, corrosion resistance, type of cladding and frame type, all need to be considered. The support will be positioned directly above the horizontal movement joint. The joint will often incorporate a compressible filler and should be of sufficient size to allow for expansion of the masonry below. Damp proofing is normally located at the support position. Wall ties should be incorporated within 300mm above and below the support.

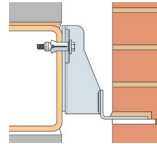

MDC/TC Support System
Incorporating Individual
Top Cleat And Expansion Bolt

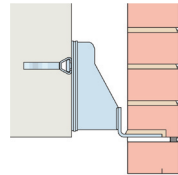

MDC Support System With Shims

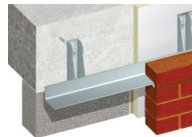

MDC Support System Fixed With
Single Expansion Bolts

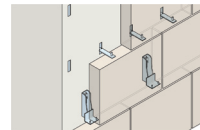

MDC/SC Stonework Support System

Fixing Methods

There are various methods of fixing support systems to the structure. Cast in channels with "T" bolts or site drilled expansion bolts can be used with concrete frames. For steel frames the choice is set screws or Ancon Steelgrip expanding anchors which have been designed to provide a means of fixing through steel where access is only available from one side.

Tolerances

It is important to select the correct support system to ensure that building tolerances can be accommodated. Adjustment will be required in all three planes. Ancon brackets have a slot in the back to provide vertical adjustment. A serrated surface prevents any slip. Longitudinal adjustment is provided by cast in channel in concrete structures, or by providing slots in steel framed structures.

For further information, advice and pricing on specific applications please contact Dorsey.

Bi-metallic Contact

Corrosion of the steel frame may be slightly increased where there is direct contact with stainless steel in a damp environment. This will not affect the stainless steel and can be avoided by isolating the two dissimilar metals. This can be achieved by incorporating a separating membrane.



Ancon & Dorsey

Dorsey have worked closely with Ancon for many years providing our customers with the very best advice, products and technical support.