

# Cavibrick Rectangular to Round Converter Sleeve

- Compatible with Cavibrick
- Fits standard pipe
- Unobstructed airflow

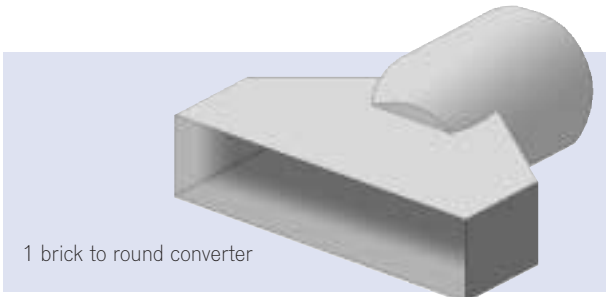

1 brick to round converter

## use

Permits cavibrick to be connected to standard pipe.

## introduction

Where it is proposed to provide ventilation to a remote room, under floor area or void, a rectangular to round converter sleeve is available to permit the use of standard 100mm nominal plastic soil pipe.

The cavibrick promotes excellent air throughput that can be conveyed using standard pipe if

so required. We recommend sleeves are protected with a cavitray where they pass through the cavity, to comply with NHBC/best practice. (See Sleeve and Duct Cavitrays.)

## data

- Black polypropylene.
- Size 70mm x 225mm + circular connection.
- Accepts standard single cavibrick.
- Packed in boxes containing 10no.
- Also available individually.

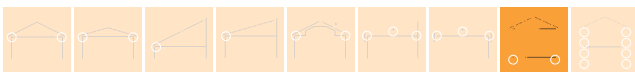

Consider for use where shown. See inside cover for key.

# Sleeve and Duct Cavitrays

- Suits range of cavity sizes
- Compatible with all sleeves
- Prevents tracking

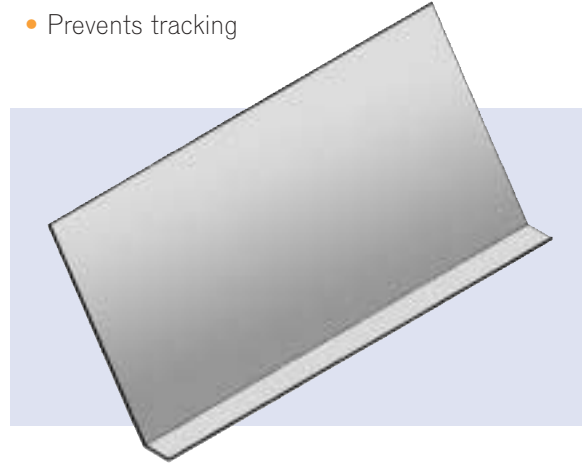

## use

Preformed trays to protect sleeves and ducts where they pass through a cavity wall.

## introduction

Where a straight or cranked sleeve/duct passes through a cavity, measures should be taken to ensure penetrating water cannot use the upper surface of the sleeve/duct as a means to reach the inside skin. Use of a preformed cavitray prevents water bridging and promotes compliance of the Building Regulations.

The requirement to provide such protection is highlighted in the latest British Standard 5628-3:2001, which specifically refers to ducts and pipes. Recommended for use with Type TAV, straight, and rectangular to round converters.

## data

- Solid DPC preformed trays.
- May be used in cavities from 50mm to 140mm.
- Size 330mm x 160mm x 50mm.
- Packed in boxes containing 50no.
- Smaller quantities available.



Consider for use where shown. See inside cover for key.