

Technical Data Sheet

Rytons '9 x 6' All-Purpose Ventilation Set with Hit & Miss Ventilator (Reduces Light and Draughts)

www.vents.co.uk CAVITY section

April 2005

Dimensional Drawing

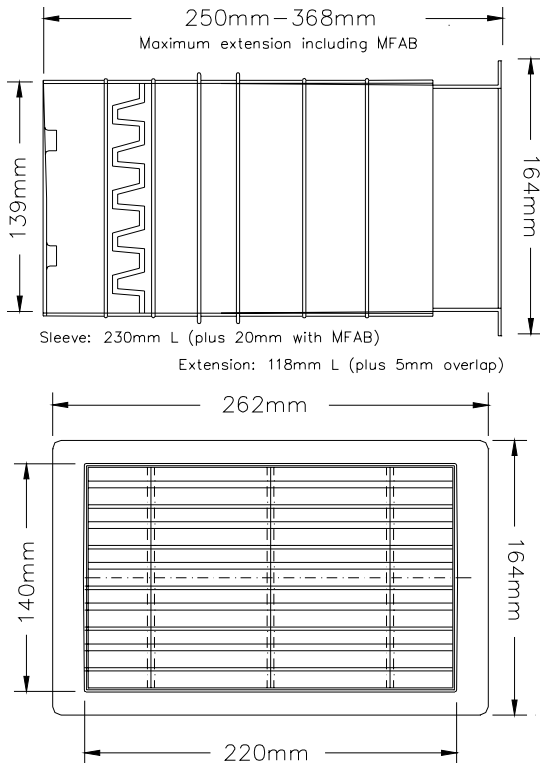

U.V. stabilised
air brick and hit & miss vent.

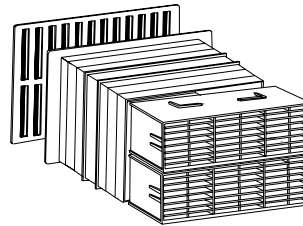

Irish Reg. Stat.

Main Uses, Features and Benefits

- Background ventilator.
- Alternative to trickle ventilators in windows.
- Meets 8000mm² regulation requirements.
- Internal baffles reduce light and draughts.
- Finished with adjustable internal hit & miss ventilator.
- Set contains Rytons Multifix[®] Air Brick '9x6', Rytons '9x6' All-Purpose AirLiner[®] (TCL16000) and Rytons Hit & Miss Ventilator '9x6' (HM85F).

F30 Accessories/Sundry Items for Brick/Block/Stone Walling
171 VENTILATION DUCTS IN EXTERNAL WALLING
U90 General Ventilation - Domestic
340 THROUGH WALL VENTILATOR DUCT

Product Specification Code

Rytons TC16HM.

Size

220mm (W) x 140mm (H).

Extends from 250mm to 368mm (L) with Rytons Multifix[®] Air Brick fitted.

Free Area

8600mm² (86cm²) (13¼"²) per unit.

Composition

MFAB: U.V. stabilised polypropylene.

TCL16000: Polypropylene.

HM85F: U.V. stabilised high impact polystyrene.

Colours

MFAB: Grey, black, buff/sand, terracotta, white, brown, blue/black.

TCL16000: Black.

HM85F: White.

Specification Paragraph

Manufacturer:

Rytons Building Products Ltd Tel: 01536 511874 Fax: 01536 310455

Email: admin@rytons.com Web: www.vents.co.uk (updated regularly)

Product ref:

- Rytons '9 x 6' All-Purpose Ventilation Set Grey (ref TC16HMGR)
- Rytons '9 x 6' All-Purpose Ventilation Set Black (ref TC16HMBL)
- Rytons '9 x 6' All-Purpose Ventilation Set Buff/Sand (ref TC16HMBS)
- Rytons '9 x 6' All-Purpose Ventilation Set Terracotta (ref TC16HMTC)
- Rytons '9 x 6' All-Purpose Ventilation Set White (ref TC16HMWH)
- Rytons '9 x 6' All-Purpose Ventilation Set Brown (ref TC16HMDB)
- Rytons '9 x 6' All-Purpose Ventilation Set Blue/Black (ref TC16HMBB)

In-Situ Line Drawing

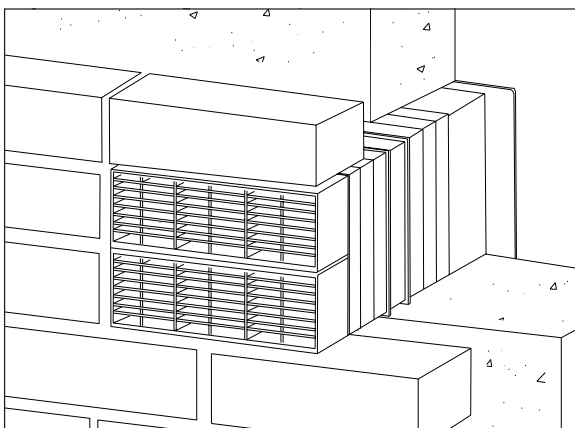

Technical Data Sheet

Rytons '9 x 6' All-Purpose Ventilation Set with Hit & Miss Ventilator (Reduces Light and Draughts)

www.vents.co.uk CAVITY section

April 2005

Photo Library

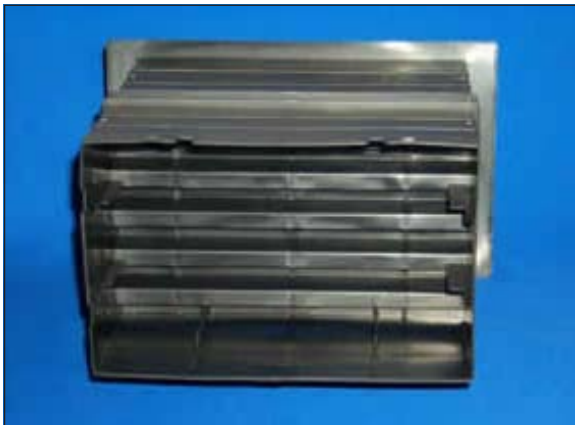

Installation

No special fixing required. Build in air brick and cavity liner as work proceeds. Extend telescopic sleeve as necessary. Fasten hit & miss ventilator into the flange of the AirLiner® to finish. Consideration should be given to using Rytons '9 x 6' Cowl (ABC6) in exposed areas.

Extra Features and Benefits

Individually boxed sets for easy identification, handling and efficient installation.

Air brick louvres promote unrestricted air flow and reduce risk of blockage as well as keeping large insects out. Also features built-in water baffles to prevent water penetration.

External water baffles prevent transfer of water across the cavity.

Flush face and slim design of hit & miss vent maintains aesthetic appearance.

Hit & miss vent features integral flyscreen promoting unrestricted air flow.

Hit & miss vent is quickly and easily installed and removed for cleaning.

BBA Approval

All components BBA approved. Rytons has **59** British Board of Agrément approved products; the largest range on the market. BBA certification is third party evaluation and accreditation, and approved products are accepted by building control officers, architects, engineers and surveyors nationwide. The NHBC also accept products approved by the BBA when used as stated in the relevant BBA certificate. Rytons also has an Irish Building Regulation Statement for each of their three BBA certificates.

UK Regulations, Standards and Guidelines

For heat producing appliances refer to:

The Building Regulations Approved Document J.

The Building Standards (Scotland) Technical Standards Part F.

British Standard BS 5440-2:2000.

For decorative fuel effect gas fires refer to:

British Standard BS 5871-3:2001.

For background ventilation refer to:

The Building Regulations Approved Document F.

The Building Standards (Scotland) Technical Standards Part K2 and K4.

British Standard BS 5250:2002.

Questions

What can I use to extend the AirLiner®?

Rytons '9 x 6' AirLiner® Extension (see data sheet [dstcl96ext](#)).

How high should a background ventilator be fitted?

The Building Regulations Approved Document F states typically 1.7m above floor level to avoid discomfort due to cold draughts.

Is a cowed option available for exposed areas?

Yes (see data sheet [dstc16hcw](#)).

What is the Effective Free Area of the set?

7900mm² (79cm²) per unit.

What is the difference between Free Area and Effective Free Area?

Free Area is Rytons calculation of air space achieved by measuring the minimum unobstructed gaps in a vent through which air can pass.

Effective Free Area is a calculated reading of how much air passes through a vent using the test procedure referred to in BS 5440-2:2000.